

\$0 - 10710 103, Edmonton

MLS® #E4446455

\$0
0 Bedroom, 0.00 Bathroom,
Land Commercial on 0.00 Acres

Central Mcdougall, Edmonton, AB

A rare opportunity to lease a MIXED-USE Commercial lot in Central McDougall. Visualize your profitable business idea taking place on these 7,500 square foot lot.

Essential Information

MLS® #	E4446455
Bathrooms	0.00
Acres	0.00
Type	Land Commercial
Status	Active

Community Information

Address	10710 103
Area	Edmonton
Subdivision	Central Mcdougall
City	Edmonton
County	ALBERTA
Province	AB
Postal Code	T5H 2V8

Additional Information

Date Listed	July 8th, 2025
Days on Market	5
Zoning	Zone 08

DATA IS DEEMED RELIABLE BUT IS NOT GUARANTEED ACCURATE BY THE REALTORS® ASSOCIATION OF EDMONTON. COPYRIGHT 2025 BY THE REALTORS® ASSOCIATION OF EDMONTON. ALL RIGHTS

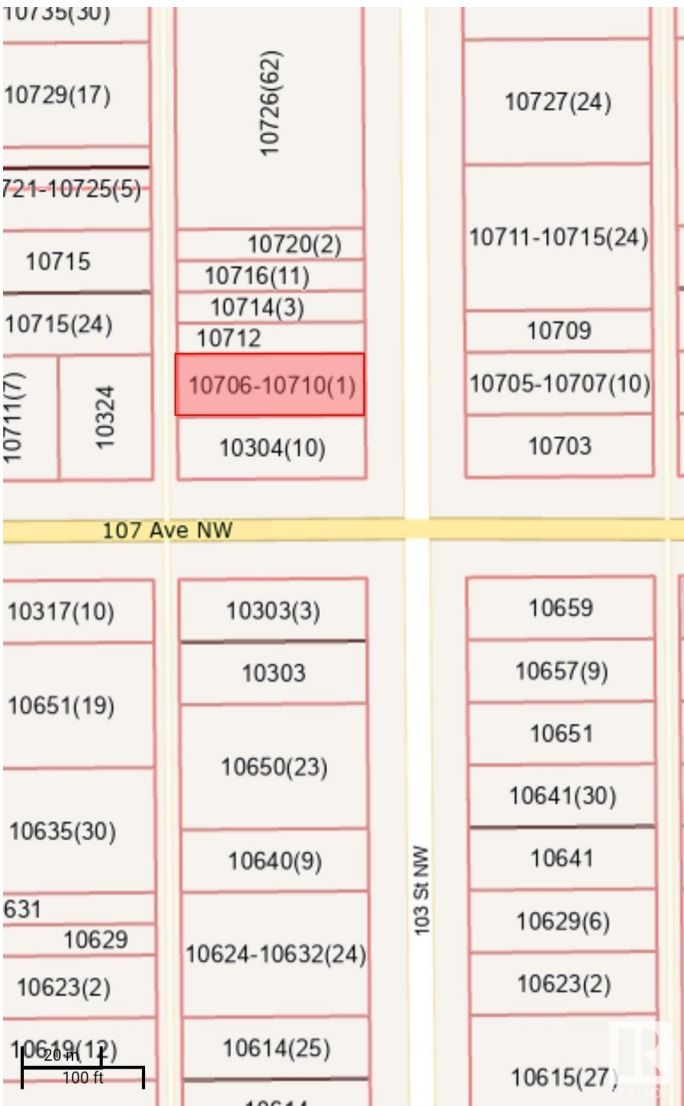

RESERVED.Trademarks are owned or controlled by the Canadian Real Estate Association (CREA) and identify real estate professionals who are members of CREA (REALTOR®, REALTORS®) and/or the quality of services they provide (MLS®, Multiple Listing Service®)

Listing information last updated on July 13th, 2025 at 8:32pm MDT